



PE182T-1.5-6

GENERAL PURPOSE ELECTRIC MOTOR

NEMA PREMIUM EFFICIENCY

TOTALLY ENCLOSED FAN COOLED

INVERTER DUTY 10:1 CT; 20:1 VT - NEMA MG1 PART 31

Factory Certified for T2B Class I, Division II, Groups A,B,C & D and Class II, Division II, Groups F & G

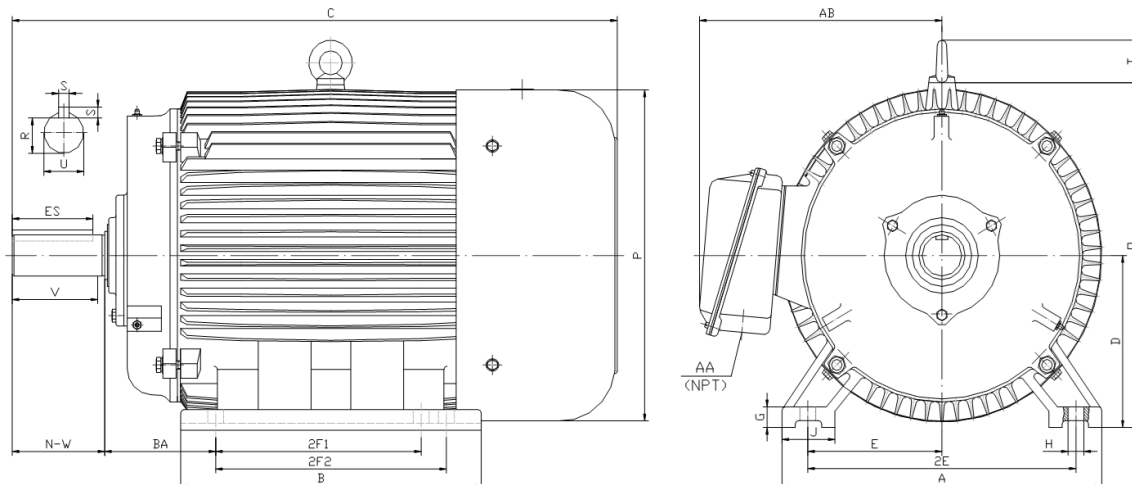

DIMENSIONS

HP	RPM	Frame	MOUNTING														
			A	B	C	D	G	H	J	E	2E	2F1	2F2	O	P	T	BA
1.5	1200	182T	9.50	7.30	16.10	4.50	0.60	0.41	2.00	3.75	7.50	4.50	5.50	9.10	8.70	1.60	2.75

Shaft Extension, Key Set						Conduit Box		Bearings		Mount
U	V	R	S	ES	N-W	AA	AB	DE	ODE	
1.125	2.50	0.986	0.250	1.78	2.75	0.75	7.50	6306-ZZ	6306-ZZ	F1

BEARING LUBRICATION: The bearings come lubricated with Mobil Polyrex EM Polyurea Grease.

ISO9001
CERTIFIED



NEMA
Premium



ElectricalHelper.org

For All Your Electric Needs Since 1928

411 N Platte Ave. York, NE. 68467

AC-DC MOTORS :: SALES & SERVICE

REWINDING :: CUSTOM CONTROL PANEL

Kelly MacMillan

Office PH: 888.226.4917 Ext. 102

Fax: 888.226.4917

Cell: 402.679.1579

E-Mail: kelly@electricalhelper.com



PE182T-1.5-6

GENERAL PURPOSE ELECTRIC MOTOR

NEMA PREMIUM EFFICIENCY

TOTALLY ENCLOSED FAN COOLED

INVERTER DUTY 10:1 CT; 20:1 VT - NEMA MG1 PART 31







Factory Certified for T2B Class I, Division II, Groups A,B,C & D and Class II, Division II, Groups F & G

PERFORMANCE DATA

HP	RPM	Frame	Voltage	Frequency (Hz)	Full Load S.F.	Insulation Class	NEMA Design	Slip (%)	NEMA Code	Enclosure Type	IP Rating	Max. Ambient
1.5	1175	182T	208-230/460	60	1.15	F	B	2.1	M	TEFC	55	40° C

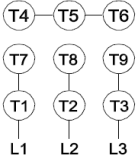
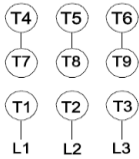
Amps (460V)		Efficiency (%)				Power Factor			Torque (ft-lb)			DE Bearing	ODE Bearing	Connection	Weight (lbs.)
FLA	LRA	100%	75%	50%	Min.	100%	75%	50%	FLT	LRT %	BDT %	6306-ZZ	6306-ZZ	9 Lead 2Y/Y	87
2.4	20	87.5	86.5	84.0	85.5	0.680	0.590	0.470	6.8	200	290				

NAME PLATE

<div><div></div><div>North American Electric, Inc.</div></div> <div><div></div></div>										CONNECTION DIAGRAMS	
INVERTER DUTY 20:1 VT; 10:1 CT											
CAT NO: PE182T-1.5-6				FRAME 182T				PHASE 3		<div>208-230V</div> <div></div>	
HZ 60		S.F. 1.15		HZ 50		S.F. 1.0		ENCL TEFC IP 55			
HP 1.5		RPM 1175		HP 1.5		RPM 970		DUTY CONT DES B			
VOLTS 208-230/460				VOLTS 190/380				AMB 40° C INS F			
FLA 5.2 - 4.8 / 2.4				FLA 5.6/2.8				DE BEARING 6306-ZZ			
CODE M		P.F. 0.68		CODE K		P.F. 0.73		ODE BEARING 6306-ZZ		<div>460V</div> <div></div>	
EFF 87.5		MIN 85.5		EFF 85.5		MIN 83.5		LUB: Mobil Polyrex EM			
MOTOR WEIGHT 87 LBS				CONNECTION 9 Lead 2Y/Y				SER NO			
General purpose use on industrial machinery installed in damp, dusty or dirty environments.											
<div><div></div><div></div><div></div><div>CC 082A</div></div>											

APPLICATIONS:

General purpose use on pumps, fans, blowers, compressors, conveyors, material handling and other industrial machinery installed in damp, dusty or dirty environments.



ElectricalHelper.org

For All Your Electric Needs Since 1928

411 N Platte Ave. York, NE. 68467

AC-DC MOTORS :: SALES & SERVICE

REWINDING :: CUSTOM CONTROL PANEL

Kelly MacMillan

Office PH: 888.226.4917 Ext. 102

Fax: 888.226.4917

Cell: 402.679.1579

E-Mail: kelly@electricalhelper.com