



PE213T-7.5-2

GENERAL PURPOSE ELECTRIC MOTOR

NEMA PREMIUM EFFICIENCY

TOTALLY ENCLOSED FAN COOLED

INVERTER DUTY 10:1 CT; 20:1 VT - NEMA MG1 PART 31

Factory Certified for T2B Class I, Division II, Groups A,B,C & D and Class II, Division II, Groups F & G

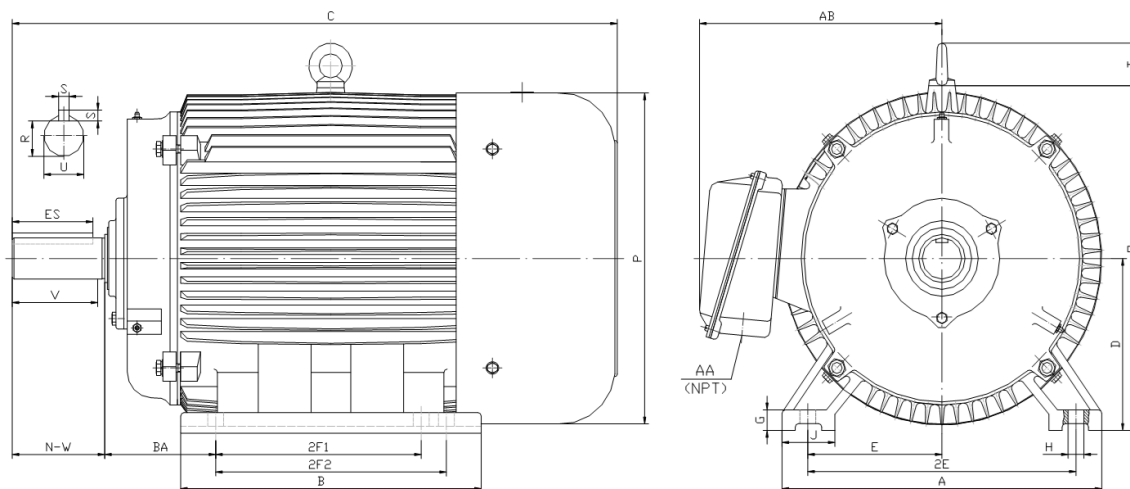

DIMENSIONS

HP	RPM	Frame	MOUNTING														
			A	B	C	D	G	H	J	E	2E	2F1	2F2	O	P	T	BA
7.5	3600	213T	11.00	7.90	18.90	5.25	0.70	0.41	2.40	4.25	8.50	5.50	0.00	10.50	10.20	1.90	3.50

Shaft Extension, Key Set						Conduit Box		Bearings		Mount
U	V	R	S	ES	N-W	AA	AB	DE	ODE	
1.375	3.12	1.201	0.312	2.41	3.38	1.00	8.30	6308-ZZ	6308-ZZ	F1

BEARING LUBRICATION: The bearings come lubricated with Mobil Polyrex EM Polyurea Grease.

ISO9001
CERTIFIED



NEMA
Premium



ElectricalHelper.org

For All Your Electric Needs Since 1928
411 N Platte Ave. York, NE. 68467

AC-DC MOTORS :: SALES & SERVICE
REWINDING :: CUSTOM CONTROL PANEL

Kelly MacMillan

Office PH: 888.226.4917 Ext. 102

Fax: 888.226.4917

Cell: 402.679.1579

E-Mail: kelly@electricalhelper.com



PE213T-7.5-2

GENERAL PURPOSE ELECTRIC MOTOR

NEMA PREMIUM EFFICIENCY

TOTALLY ENCLOSED FAN COOLED

INVERTER DUTY 10:1 CT; 20:1 VT - NEMA MG1 PART 31







Factory Certified for T2B Class I, Division II, Groups A,B,C & D and Class II, Division II, Groups F & G

PERFORMANCE DATA

HP	RPM	Frame	Voltage	Frequency (Hz)	Full Load S.F.	Insulation Class	NEMA Design	Slip (%)	NEMA Code	Enclosure Type	IP Rating	Max. Ambient
7.5	3530	213T	208-230/460	60	1.15	F	B	1.9	H	TEFC	55	40° C

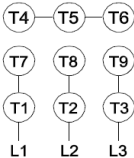
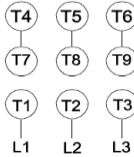
Amps (460V)		Efficiency (%)					Power Factor			Torque (ft-lb)			DE Bearing	ODE Bearing	Connection	Weight (lbs.)
FLA	LRA	100%	75%	50%	Min.	100%	75%	50%		FLT	LRT %	BDT %				
8.8	63	89.5	88.5	86.0	87.5	0.900	0.870	0.810		11.2	160	290	6308-ZZ	6308-ZZ	9 Lead 2Y/Y	154

NAME PLATE

 North American Electric, Inc.														CONNECTION DIAGRAMS					
INVERTER DUTY 20:1 VT; 10:1 CT																			
CAT NO: PE213T-7.5-2						FRAME 213T				PHASE 3				<div>208-230V</div> 					
HZ 60		S.F. 1.15		HZ 50		S.F. 1.0		ENCL TEFC		IP 55									
HP 7.5		RPM 3530		HP 7.5		RPM 2920		DUTY CONT		DES B									
VOLTS 208-230/460				VOLTS 190/380				AMB 40° C		INS F									
FLA 18.8 - 17.6 / 8.8				FLA 21/10.5				DE BEARING 6308-ZZ											
CODE H		P.F. 0.90		CODE E		P.F. 0.92		ODE BEARING 6308-ZZ											
EFF 89.5		MIN 87.5		EFF 87.5		MIN 85.5		LUB: Mobil Polyrex EM											
MOTOR WEIGHT 154 LBS				CONNECTION 9 Lead 2Y/Y				SER NO				<div>460V</div> 							
General purpose use on industrial machinery installed in damp, dusty or dirty environments.																			
  														CC 082A					

APPLICATIONS:

General purpose use on pumps, fans, blowers, compressors, conveyors, material handling and other industrial machinery installed in damp, dusty or dirty environments.



ElectricalHelper.org

For All Your Electric Needs Since 1928
411 N Platte Ave. York, NE. 68467

AC-DC MOTORS :: SALES & SERVICE
REWINDING :: CUSTOM CONTROL PANEL

Kelly MacMillan

Office PH: 888.226.4917 Ext. 102

Fax: 888.226.4917

Cell: 402.679.1579

E-Mail: kelly@electricalhelper.com