

PE284T-25-2

GENERAL PURPOSE ELECTRIC MOTOR

NEMA PREMIUM EFFICIENCY

TOTALLY ENCLOSED FAN COOLED

INVERTER DUTY 10:1 CT; 20:1 VT - NEMA MG1 PART 31

Factory Certified for T2B Class I, Division II, Groups A,B,C & D and Class II, Division II, Groups F & G

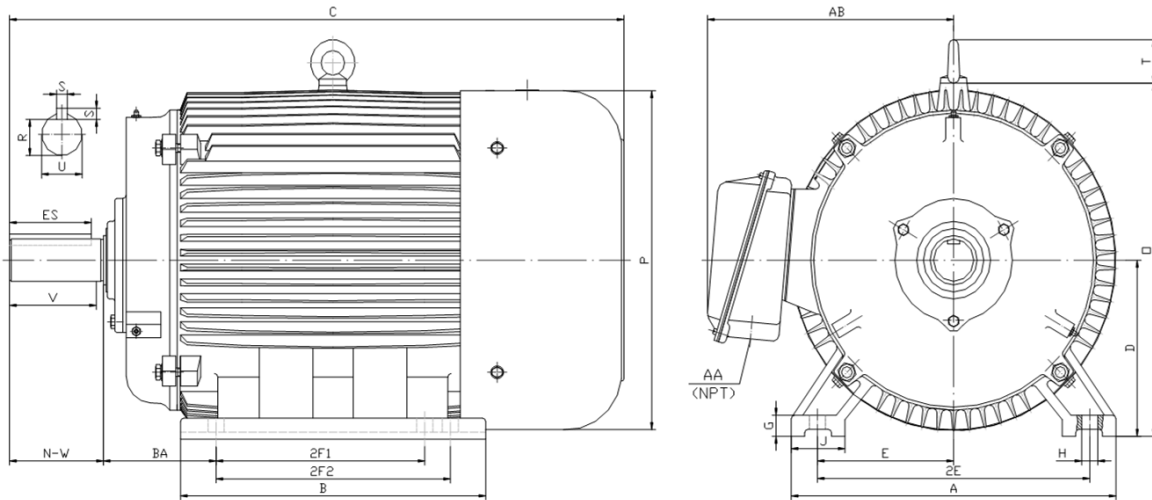

DIMENSIONS

| HP | RPM | Frame | MOUNTING | | | | | | | | | | | | | | |
|----|------|-------|----------|-------|-------|------|------|------|------|------|-------|------|------|-------|-------|------|------|
| | | | A | B | C | D | G | H | J | E | 2E | 2F1 | 2F2 | O | P | T | BA |
| 25 | 3600 | 284T | 14.00 | 13.20 | 26.60 | 7.00 | 0.85 | 0.53 | 2.75 | 5.50 | 11.00 | 9.50 | 0.00 | 14.50 | 14.00 | 2.20 | 4.75 |

| Shaft Extension, Key Set | | | | | | Conduit Box | | Bearings | | Mount |
|--------------------------|------|-------|-------|------|------|-------------|-------|----------|------|-------|
| U | V | R | S | ES | N-W | AA | AB | DE | ODE | |
| 1.875 | 4.38 | 1.591 | 0.500 | 3.28 | 4.62 | 1.50 | 11.30 | 6311 | 6311 | F1 |

BEARING LUBRICATION: The bearings come lubricated with Mobil Polyrex EM Polyurea Grease. It is recommended that you add some additional lubrication when the motor is installed.

Three options (brands) for suitable lubrication include, but are not limited to, the following:

- 1.) Mobil Polyrex EM
- 2.) Citco Polyurea MP
- 3.) Conoco Phillips Polytac EP



Electrical Helper

“Practical Straight Forward Electric Wiring Solutions Since 1928.”

For Fast & Friendly Assistance Call Us
888-226-4917
Hours 8:00AM-5:00PM CST



PE284T-25-2

GENERAL PURPOSE ELECTRIC MOTOR

NEMA PREMIUM EFFICIENCY

TOTALLY ENCLOSED FAN COOLED

INVERTER DUTY 10:1 CT; 20:1 VT - NEMA MG1 PART 31







Factory Certified for T2B Class I, Division II, Groups A,B,C & D and Class II, Division II, Groups F & G

PERFORMANCE DATA

| HP | RPM | Frame | Voltage | Frequency (Hz) | Full Load S.F. | Insulation Class | NEMA Design | Slip (%) | NEMA Code | Enclosure Type | IP Rating | Max. Ambient |
|----|------|-------|-------------|----------------|----------------|------------------|-------------|----------|-----------|----------------|-----------|--------------|
| 25 | 3540 | 284T | 208-230/460 | 60 | 1.15 | F | B | 1.7 | G | TEFC | 55 | 40° C |

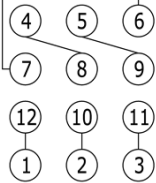
| Amps (460V) | | Efficiency (%) | | | | Power Factor | | | Torque (ft-lb) | | | DE Bearing | ODE Bearing | Connection | Weight (lbs.) |
|-------------|-----|----------------|------|------|------|--------------|-------|-------|----------------|-------|-------|------------|-------------|--------------|---------------|
| FLA | LRA | 100% | 75% | 50% | Min. | 100% | 75% | 50% | FLT | LRT % | BDT % | | | | |
| 28.0 | 182 | 91.7 | 91.2 | 90.0 | 90.2 | 0.900 | 0.870 | 0.810 | 37.2 | 150 | 240 | 6311 | 6311 | 12 Lead 2Δ/Δ | 385 |

NAME PLATE

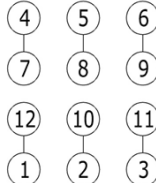
| | | | | | | | | | | | | | | | |
|--|-----------|-------------------------|---------------|-----------|--------|-----------------|--|-----------------------|-------|---|--|--|--|--|--|
|  North American Electric, Inc. | | | | | | | | | |  | | | CONNECTION DIAGRAMS 208-230V  | | |
| INVERTER DUTY 20:1 VT; 10:1 CT | | | | | | | | | | | | | | | |
| CAT NO: PE284T-25-2 | | | FRAME 284T | | | PHASE 3 | | | | | | | | | |
| HZ 60 | S.F. 1.15 | HZ 50 | S.F. 1.0 | ENCL TEFC | IP 55 | | | | | | | | | | |
| HP 25 | RPM 3540 | HP 25 | RPM 2930 | DUTY CONT | DES B | | | | | | | | | | |
| VOLTS 208-230/460 | | | VOLTS 190/380 | | | AMB 40° C | | | INS F | | | | | | |
| FLA 61.9 - 56 / 28 | | | FLA 69/34.5 | | | DE BEARING 6311 | | | | | | | | | |
| CODE G | | P.F. 0.90 | | CODE F | | P.F. 0.91 | | ODE BEARING 6311 | | | | | | | |
| EFF 91.7 | | MIN 90.2 | | EFF 90.2 | | MIN 88.5 | | LUB: Mobil Polyrex EM | | | | | | | |
| MOTOR WEIGHT 385 LBS | | CONNECTION 12 Lead 2Δ/Δ | | | SER NO | | | | | | | | | | |
| General purpose use on industrial machinery installed in damp, dusty or dirty environments. Hernando, Mississippi | | | | | | | | | |    CC 082A | | | | | |
| | | | | | | | | | | 460V  | | | | | |

APPLICATIONS:

General purpose use on pumps, fans, blowers, compressors, conveyors, material handling and other industrial machinery installed in damp, dusty or dirty environments.



Electrical Helper

"Practical Straight Forward Electric Wiring Solutions Since 1928."

For Fast & Friendly Assistance Call Us
888-226-4917

Hours 8:00AM-5:00PM CST