

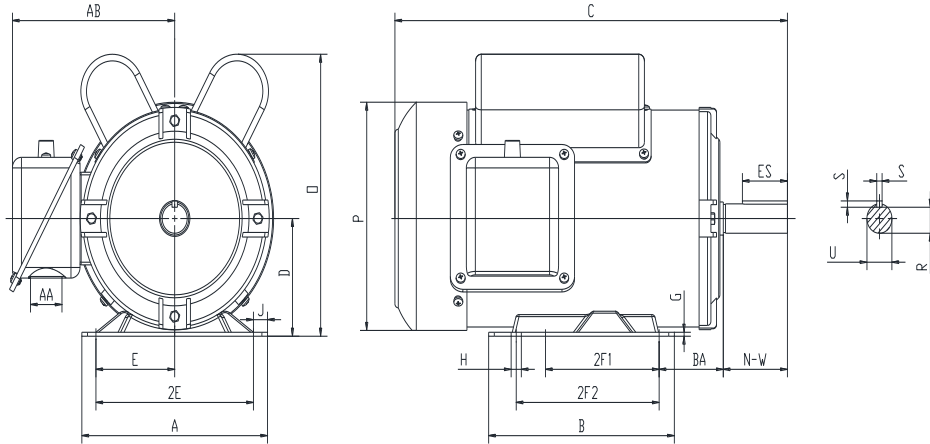

F145T2S4C-MO

**FARM DUTY ELECTRIC MOTOR
 HIGH STARTING TORQUE - MANUAL OVERLOAD
 SINGLE PHASE - CAPACITOR START / CAPACITOR RUN
 ROLLED STEEL CONSTRUCTION
 TOTALLY ENCLOSED FAN COOLED**



DIMENSIONS

HP	RPM	Frame	MOUNTING														
			A	B	C	D	G	H	J	E	2E	2F1	2F2	O	P	T	BA
2	1800	145T	6.5	6.5	13.8	3.5	0.12	0.34	0.5	2.75	5.5	4	5	8.5	6.8	NA	2.25

Shaft Extension, Key Set						Conduit Box		Bearings		Mount
U	V	R	S	ES	N-W	AA	AB	DE	ODE	
0.875	NA	0.771	0.188	1.41	2.25	1.1	6	6205-2RZC3	6203-2RZC3	F1

BEARING LUBRICATION: The bearings come lubricated with Mobil Polyrex EM Polyurea Grease.



Electrical Helper.org

For All Your Electric Needs Since 1928
 411 N Platte Ave. York, NE. 68467

**AC-DC MOTORS :: SALES & SERVICE
 REWINDING :: CUSTOM CONTROL PANEL**

Kelly MacMillan
 Office Ph: 888-226-4917
 Fax: 888-226-4917
 Cell: 402-679-1579
 E-Mail: kelly@electricalhelper.com





F145T2S4C-MO





FARM DUTY ELECTRIC MOTOR
HIGH STARTING TORQUE - MANUAL OVERLOAD
SINGLE PHASE - CAPACITOR START / CAPACITOR RUN
ROLLED STEEL CONSTRUCTION
TOTALLY ENCLOSED FAN COOLED

PERFORMANCE DATA

HP	RPM	Frame	Voltage	Frequency (Hz)	Full Load S.F.	Insulation Class	NEMA Design	Slip (%)	NEMA Code	Enclosure Type	IP Rating	Max. Ambient
2	1750	145T	115/208-230	60	1.15	F	L	2.8	H	TEFC	55	40 °C

Amps (230V)		Efficiency (%)			Power Factor			Torque (ft-lb)			DE Bearing	ODE Bearing	Connection	Weight (lbs.)
FLA	LRA	100%	75%	50%	100%	75%	50%	FLT	LRT %	BDT %				
8	53.9	83.6	81.6	76.3	0.96	0.96	0.93	6.04	266	229	6205-2RZC3	6203-2RZC3	5 Lead/P1,P2	53

NAME PLATE

 FARM DUTY SINGLE PHASE AC ELECTRIC MOTOR HIGH STARTING TORQUE MANUAL OVERLOAD PROTECTION																																							
MODEL	F145T2S4C-MO	HP	2																																				
FRAME	145T	ENCL	TEFC																																				
RPM	1750	CODE	H																																				
DESIGN	L	CLASS	F																																				
EFFICIENCY	83.6	P.F.	0.96																																				
DE BRG	6205-2RZC3	ODE BRG	6203-2RZC3																																				
VOLT	115/208-230	LBS	53																																				
AMPS	16/8.9-8	DUTY	CONT																																				
S.F.AMPS	18.4/10.24-9.2	MAX AMB	40 °C																																				
CONNECTION	5 Lead/P1,P2	SER #																																					
<table border="0"> <tr> <td colspan="2">115V</td> <td colspan="2">208-230V</td> </tr> <tr> <td>CCW</td> <td>LOW VOLTAGE</td> <td>CW</td> <td>HIGH VOLTAGE</td> </tr> <tr> <td>P1</td> <td>L1</td> <td>P1</td> <td>L1</td> </tr> <tr> <td>P2</td> <td></td> <td>P2</td> <td>P2</td> </tr> <tr> <td>T3</td> <td></td> <td>T3</td> <td>T2</td> </tr> <tr> <td>T8</td> <td></td> <td>T5</td> <td>T3</td> </tr> <tr> <td>T2</td> <td></td> <td>T2</td> <td>T8</td> </tr> <tr> <td>T4</td> <td>L2</td> <td>T4</td> <td>T4</td> </tr> <tr> <td>T5</td> <td></td> <td>T8</td> <td>T5</td> </tr> </table>				115V		208-230V		CCW	LOW VOLTAGE	CW	HIGH VOLTAGE	P1	L1	P1	L1	P2		P2	P2	T3		T3	T2	T8		T5	T3	T2		T2	T8	T4	L2	T4	T4	T5		T8	T5
115V		208-230V																																					
CCW	LOW VOLTAGE	CW	HIGH VOLTAGE																																				
P1	L1	P1	L1																																				
P2		P2	P2																																				
T3		T3	T2																																				
T8		T5	T3																																				
T2		T2	T8																																				
T4	L2	T4	T4																																				
T5		T8	T5																																				
Hernando, MS www.naemotors.com																																							
  																																							

APPLICATIONS:

General purpose use on pumps, fans, conveyors, poultry equipment, air compressors and other farm duty machinery requiring high starting torques.



Electrical Helper.org

For All Your Electric Needs Since 1928
 411 N Platte Ave. York, NE. 68467

AC-DC MOTORS :: SALES & SERVICE
REWINDING :: CUSTOM CONTROL PANEL

Kelly MacMillan

Office Ph: 888-226-4917

Fax: 888-226-4917

Cell: 402-679-1579

E-Mail: kelly@electricalhelper.com

