

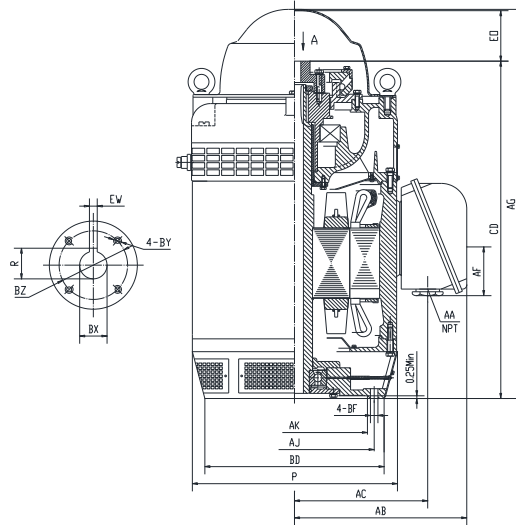

V1-40D4-W32416A

VERTICAL HOLLOW SHAFT MOTOR
NEMA PREMIUM EFFICIENCY
INVERTER RATED 10:1 VT
HIGH THRUST DESIGN
THREE PHASE, OPEN DRIP PROOF (WP1) ENCLOSURE
NON-REVERSE BALL TYPE RATCHET
COUPLING INCLUDED



DIMENSIONS

HP	RPM	Frame	MOUNTING DIMENSIONS													
			BD	AJ	AK	BF	BX	BZ	EW	R	BY	CD	E0 >	AC	AA	AF
40	1784	324TP	16.5	14.75	13.5	0.69	1-1/4	1.75	0.25	1.366	1/4-20	28.22	4.22	11.65	3	5.83

OVERALL DIMENSIONS			BEARINGS	
P	AB	AG	UPPER	LOWER
17.32	15.44	32.7	7221B	6213

COUPLING: Motor comes with a 1.25" coupling. You may select a different size coupling at no extra charge.

BEARING LUBRICATION: The lower bearing comes lubricated with Mobil Polyrex EM Polyurea Grease.

OIL RESERVOIR: Motor is shipped without oil. The oil capacity is 1.75 quarts.

STEADY BUSHING: Motor is designed to accept a steady bushing. The bore size is 1-1/4 inches.





V1-40D4-W32416A







VERTICAL HOLLOW SHAFT MOTOR
NEMA PREMIUM EFFICIENCY
INVERTER RATED 10:1 VT
HIGH THRUST DESIGN
THREE PHASE, OPEN DRIP PROOF (WP1) ENCLOSURE
NON-REVERSE BALL TYPE RATCHET
COUPLING INCLUDED

PERFORMANCE DATA

HP	RPM	Frame	Voltage	Frequency (Hz)	Full Load S.F.	Insulation Class	NEMA Design	Slip (%)	NEMA Code	Enclosure Type	IP Rating	Max. Ambient	Rating CONT
40	1784	324TP	230/460	60	1.15	F	B	0.93	H	WP1	23	40° C	S1

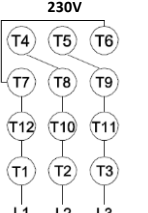
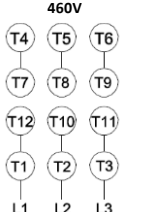
Amps (460V)		Efficiency (%)				Power Factor			Torque (ft-lb)			Down Thrust	Angular Contact Bearing	Radial Ball Bearing	Connection	Weight (lbs.)
FLA	LRA	100%	75%	50%	Min.	100%	75%	50%	FLT	LRT %	BDT %	5500	UPPER	LOWER	12 Lead 2Δ/Δ	780
46	333	94.1	93.9	92.8	93.0	0.87	0.84	0.77	116	211	250		7221B	6213		

NAME PLATE

 VERTICAL HOLLOW SHAFT HIGH THRUST DESIGN 						CONNECTION DIAGRAMS				
MODEL V1-40D4-W32416A						FRAME 324TP				
Hz	60	S.F.	1.15	ENCL	WP1	DESIGN	B			
HP	40	RPM	1784	INS	F	PHASE	3			
VOLTS	230/460	FLA	92/46	MAX.AMBIENT 40° C						
Enclosure	ODP	IP	23	RATING CONTINUOUS						
NEMA CODE	H	P.F.	0.87	MOTOR WEIGHT 780 LBS.						
NOM EFF	94.1	MIN EFF	93.0	CONNECTION 12 Lead 2Δ/Δ						
DOWN THRUST 5500			BASE DIAMETER 16.5 INCHES							
UPPER BEARING 7221B			LOWER BEARING 6213							
OIL CAP. UPPER BEARING 1.75 QTS.			LUBRICATION MOBIL POLYREX EM							
NON-REVERSE RATCHET - BALL TYPE			SERIAL NO.							
Specifically designed for use on deep well turbine pump applications. Hernando, Mississippi									CC326B	
			ROTATION 						PART WIND START CAPABLE @ 230V	
MOTOR IS SUITABLE FOR INVERTER RATED 10:1 VT										

APPLICATIONS:

Specifically designed for use on deep well turbine pump applications. The coupling is equipped with a non-reverse ratchet, which prevents motor rotation from backspin at shutdown. These motors are built to NEMA standards and have special bearing arrangements to carry heavy thrust loads.